



FLEET HOSTER



FLEET HOSTER INSTALLATION GUIDE SERIES THIS IS THE DCC07-12.

Learn how to install your device with this installation guide





Follow this article to install the DCC07-12 Dashcam.

Before you start, make sure that the vehicle is parked on an even level surface and that the windshield is clean and dry.

1. Unscrew the safety screws that locks the tamper proof case using the specialty screwdriver.
2. Insert the SIM and SD cards.
3. Attach the mounting bracket onto the camera.
4. Place the camera as high as possible on the driver side of the vehicle.
5. Remove the 3M adhesive tape cover, and mount the camera onto the windshield.

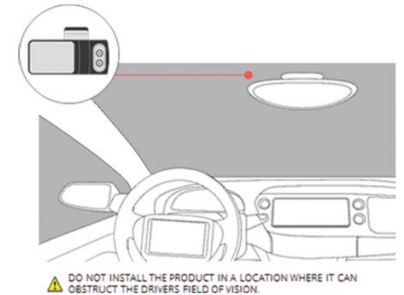
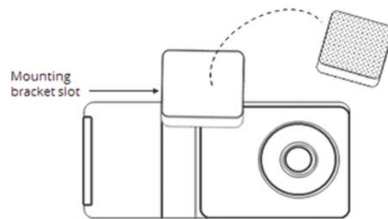
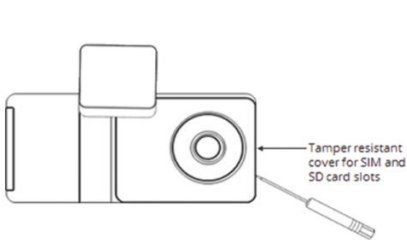

CONNECT THE DCC07-12 TO A POWER SOURCE

1. The DCC07-12 may only be connected to a power source using the supplied cables.
2. The camera's cylinder side is where the input power connector is located.
3. If using the USB cable as the power source, it must provide 5V DC and at least 2A.
4. In order to utilize the DCC07-12 full features such as active standby, the camera must be connected to a constant 12v power source.

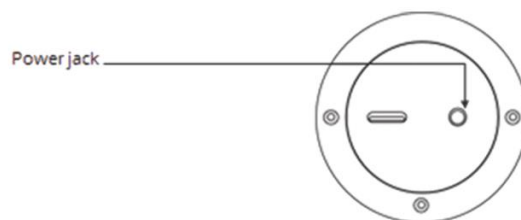



ADJUSTING THE DCC07-12 VIEWING ANGLE

1. Dismount the DCC07-12 camera from the mounting bracket on the windshield. Make sure that the mounting bracket is not attached, as it locks the camera into position.
2. Use the screwdriver to loosen the three security screws on the round side of the camera. Do not remove the screws fully.
3. Adjust the viewing angle by rotating the body of the AI-12 and lock the three side screws when finished.
4. Mount the camera back onto the windshield.
5. Connect the camera to a power source. (See section A,4)
6. The camera will turn on automatically.
7. To unlock the camera touch screen enter a default PIN number 3333
8. On the main screen enter the 'Live View' mode
9. Use the 'Live View' to direct the road facing camera and the cabin facing camera to the proper direction. You can use the arrow keys to switch between the views
10. Dismount the camera from the windshield and screw in the security screws all the way. Mount the camera back on the windshield.

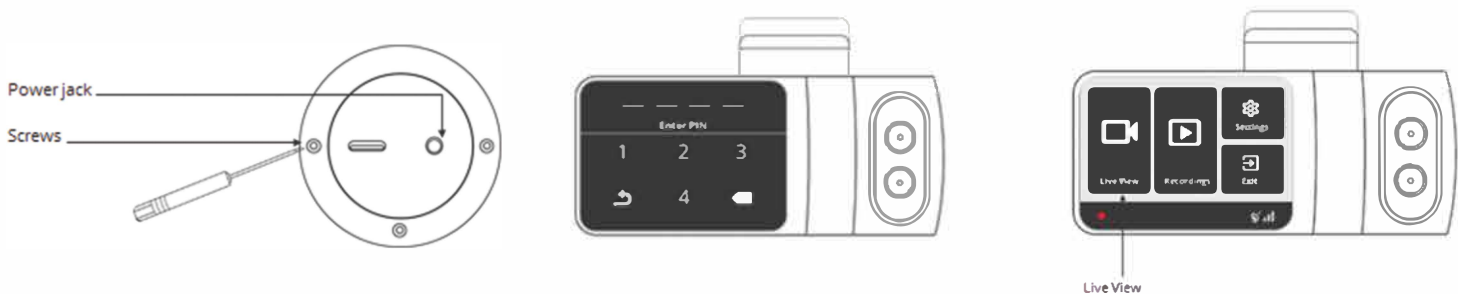

HARDWIRE TO THE VEHICLE FUSEBOX

Hardwiring a dashcam to the vehicle's fuse box is one of the most common installation methods to power on your dashcam. In order to utilize the DC07-12 full features such as active standby, the camera must be connected to a constant 12v power source.

NOTE: The hardwiring kit includes 2 wires; one **RED** wire that connects to a constant 12v source and a **BLK** ground wire that will go to a metal ground bolt.

WARNING: This type of installation should be performed by a qualified or professional person only. Working with your vehicle's power system can be dangerous for you and your vehicle. In any doubt, consult a professional.



Step 1: Locate Your Fuse Box

Check the car owner's manual for the fuse box location. It may vary depending on the vehicle model. Remove the plastic panel to access the fuse box. It may open simply by lifting a tab or pulling it with your fingers, or use a flat tool that can pinch in between the plastics.

Step 2: Which Slot Should I use?

Use a circuit tester to test which fuse is constant (typically red) and provides 12v of power. A fuse that is constant will stay active when the car is off. The camera will automatically enter standby mode when the car is not moving for 10 minutes.

Step 3: Add-A-Fuse Kit

We recommend using an add-a-fuse kit included in our Essential Install Package, for a more secure, long lasting installation. The add -a-fuse kit provides a fuse slot for the existing OEM circuit (#2 in picture below) and another fuse slot for the new circuit for the dashcam device (#1 in picture).

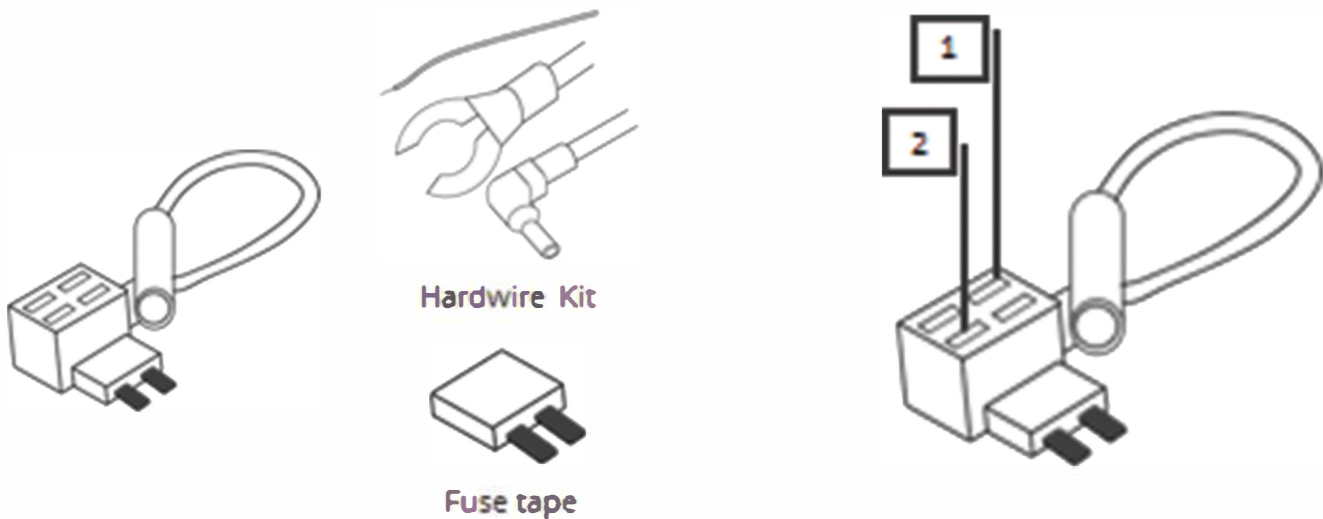

Insert the new fuse tap provided in the kit into “slot 1” , and the fuse from the fuse box into “slot 2”. If you set them with the wrong order, it will not feed power to the hardwire kit.

Connect the hardwiring cable with the terminal crimp connector from the add-a-fuse kit. Trim off some of the rubber tubing to expose the wiring on your hardwiring cable. Then crimp them down together. You should be able to crimp the fuse kit with a standard needle nose pliers. We recommend using electrical tape to further secure the wire

Connect your Add-a-Fuse Kit to the vehicle fuse slot that you have chosen.



Step 4: Ground the Hardwire Kit

The ground wire is usually in a C shape or a ring. To connect the ground wire, slip it under a metal bolt or screw in your vehicle. You may need a socket wrench set to loosen the bolt. Loosen the bolt enough to slip it in and tighten it back up afterwards. A loose ground can result in power issues for your dashcam. We recommend grounding your wire to an unpainted bare metal bolt.

Step 5: Test Your Dash Cam

Plug the power cable to the dashcam. Start your vehicle to test if the dashcam powers up. Once you tested your dashcam, run the power cable along the headliner of the car along the A-Pillar to the power source for a clean installation.

That's it. You've successfully installed your dashcam!

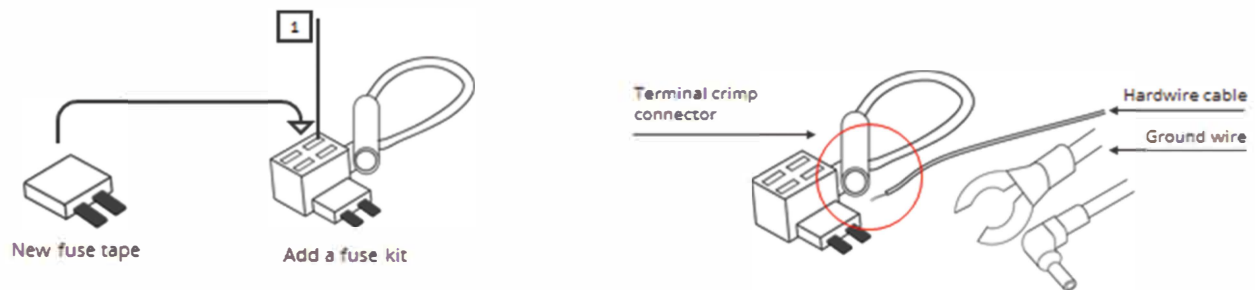

CALIBRATING THE DCC07-12 SENSORS

The DCC07-12 contains an internal accelerometer that detects unsafe driving events. The accelerometer is not calibrated in advance as the installation in every vehicle is different. Please follow the following steps to calibrate the accelerometer.

Before you start, make sure that the vehicle is parked on a level surface.

1. Turn on the vehicle's ignition.
2. Check that the camera is on.
3. Press the touchscreen and enter the security PIN.
4. Enter into the 'Settings' menu.
5. Select 'Calibrate'.

***The calibration process takes about a second and once completed.**

Note - Re-calibration is required in case of relocating or transferring the dashcam to another vehicle.



FLEETHOSTER

Schedule a demo and see how Fleet Hoster
can deliver safety for your fleet.

WWW.FLEETHOSTER.COM

